

## YHJ-151 EX-PROOF MONITOR

### PRODUCT FEATURES

- Used in ex-proof area for monitoring
- Quality LCD display
- Composite video signal input
- Plane board design for much space
- Small and easy design for easy transportation
- To adjust watching angle
- IP65
- Indoor and outdoor installation but avoid rain wash



### PRODUCT DESCRIPTION

YHJ-15 Ex-proof monitor is for ex-proof industry television equipments. Its coming out changes monitor's situation from control room to ex-proof area, this greatly improves system flexibility and will play an important role in security.

YHJ-15 adopts quality 15.1-inch LCD plate, resolution: 1024x768, pixel distance 0.297mm.

Supply voltage 220VAC.

VGA port and standard video port, support NTSC and PAL mode

Display window adopts special steel glass to make sure its good picture

Working under -0°C to +50°C longtime stably

YHJ-151 mounting could be desk type or flat place or through brackets

### SUGGESTED EQUIPMENTS

KJ2028K	Ex-proof Controller
YHFG-4	Ex-proof Quads
YHIC	Ex-proof Computer
YH-Jxd	Ex-proof Junction Box
YHNGd	Ex-proof Tube



CHANGZHOU YUHUA ELECTRIC EQUIPMENT MANUFACTURING CO.LTD  
ADDRESS: NO 60 HEHUAN ROAD, ZHONGLOU DEVELOPMENT ZONE, CHANGZHOU JIANGSU, CHINA  
TEL: 86-519-3978591 POSTAL: 213023  
FAX: 86-519-3978970 WEB: <http://www.cyh.com.cn>

2006.10 VER: 1.1



## YHJ-151 EX-PROOF MONITOR

### CERTIFICATE

Ex-marking	Exd II BT6
Certificate	CNEx04.1044
License	XK06-123-00251

### MECHANICAL

Material	1Cr18Ni9Ti or 316L
IP	IP65
Weight	28Kg
Ship weight	31Kg
Dimension	460(L) x 336(H) x 220(W) mm
Window thickness	12mm
Window area	306 x 230mm
Cable outlets	2
Screw type	G-3/4"
Mounting	Stand or by suspending bracket

### ENVIRONMENTAL

Air pressure	86~106KPa
Temperature	0℃~+50℃
Humidity	≤95%RH (+25℃)

### MOUNTING SIZE

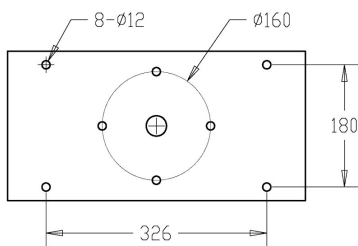

Monitor bottom mount hole

### DIMENSION

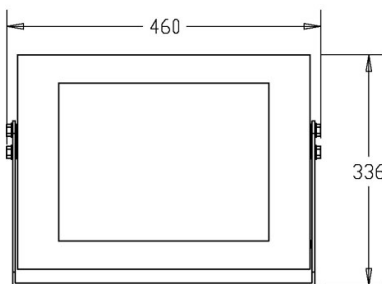

Face view

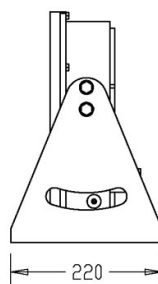

Side view

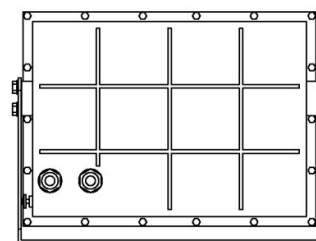

Rear view

Unit: mm.

### ELECTRICAL

Input voltage	100VAC~240VAC, 50/60Hz
Current	≤300mA
Power consumption	24W
Signal	1Vp-p composite video
Resistance	75Ω
Joint	video cable and power cable out
Other port	
RGB input	15pin D-SUB
S-VHS input	4-pin Mini DIN
Panel	1 for on/off power
Connection	2-core power cable 1-core video cable

### LCD SPECIFICATION

Panel	15.1inch (38.1cm), TFT
Color	16770000
Pixel distance	0.297mm
View area	304.1mm(W) x 228.1mm(H)
Contrast	500: 1
Brightness	300cd / m2
Horizontal angle	140° (CR>5)
Pitching angle	140° (CR>5)
Response time	16ms
Horizontal Refresh	38~60KHz
Pitching refresh	56~75Hz
Bandwidth	80MHz
Resolution	1024 x 768